

# SCHAEFER

YACHTS

A U S T R A L I A



WELCOME TO YOUR OTHER WORLD.

**SCHAEFER 770**

[WWW.SCHAEFERYACHTS.COM.AU](http://WWW.SCHAEFERYACHTS.COM.AU)

*WELCOME TO YOUR  
OTHER WORLD.*





## WELCOME TO SCHAEFER YACHTS.

At Schaefer Yachts you will find performance, technology, comfort and sophistication in harmony for you and your family to live the best moments at sea.

Now available for Australian order, be one of the first and bring another world home

### SALES

Drew Watney  
National Sales Manager  
+61 417 838 901  
[sales@schaeferyachts.com.au](mailto:sales@schaeferyachts.com.au)

### PRINCIPAL DEALER

TS8, D'Albora Marina,  
The Spit, Spit Road,  
Mosman, NSW 2088

[www.schaeferyachts.com.au](http://www.schaeferyachts.com.au)



## INDUSTRY LEADER

Schaefer Yachts is an industry leader in the design and construction of performance yachts between 30 and 83 feet. Boasting one of the biggest and most technologically advanced shipyards in South America, Schaefer Yachts has been transforming the marine industry for over 27 years. More than three thousand boats have been delivered worldwide. The shipyard has earned an exceptional reputation for setting high quality manufacturing standards with our proprietary and highly advanced production process.

The shipyard's cutting-edge technology and eagle eye for details guarantee a vast range of vessels made with extreme precision. Schaefer Yachts is proud to be a shipyard that attends to the most demanding markets in the world.



## SCHAEFER 770

Since its inception more than 27 years ago, Schaefer Yachts has continuously invested in research, innovation and technology. With the all-new Schaefer 770, another milestone for the shipyard and the nautical market has been set. A bold, modern and sophisticated design resulting in a stunning yacht. Two 17' long side-doors open to form a vast entertainment area while well designed lines convey a modern look. Advanced technology in design and construction allow a better use of space for your comfort and leisure. Meet the all-new Schaefer 770 and discover an unparalleled yacht - more spacious and more advanced than any other before.



CABINS



MAIN DECK

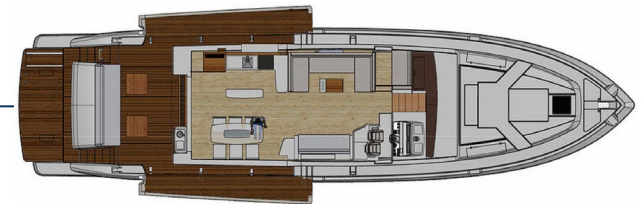

FLYBRIDGE DECK







## MORE DESIGN FOR YOUR DAYS ON BOARD

Designed entirely by SCHAEFER's engineering team, the platform submerges 2 feet below the waterline and can lift up to 800kg, perfect for a Jetski or a tender. A boarding ladder is elegantly integrated into the platform and emerges to assist you to safely get back onto the boat. Details that provide comfort and elegance for your days on the water.

## MORE SPACE, MORE COMFORT

The new Schaefer 770 is a revolution in exterior and interior design. The single level design of salon, galley and bar as well as the outdoor spaces with its expansive balconies connects everyone on board and most importantly – everyone with the sea.

## CHARMING DIFFERENCES

When we talk about the flybridge, we think: the bigger the better. And on the Schaefer 770 there's plenty of room to innovate. The wet bar, the barbecue, the large sofa for 6 people, the state-of-the-art command station and last but not least the hot tub, convince at first sight.

## HANDMADE ELEGANCE

Refinement in workmanship and extreme attention to detail are features of all Schaefer Yachts. Tastefully selected materials blend with advanced craftsmanship, resulting in elegance and sophistication for a luxurious and cozy environment.

## SOPHISTICATION AND TECHNOLOGY

Equipped with the latest electronics, navigating a Schaefer Yacht is like piloting a plane. With multi-touch panels, joystick driving and sophisticated sensors, you have full control over the boat at your fingertips. Get on a Schaefer Yacht and discover the concept of modern and easy boating.

## SPECIFICATIONS



<b>Max. length</b>	23.56 m (77.3')	<b>Fresh water capacity</b>	1,100 L (290 gal)
<b>Max. beam</b>	5.86 m (19.2')	<b>Fuel capacity</b>	3,800 L (1,004 gal)
<b>Max. draft</b>	1.58 m (5.2')	<b>Passenger capacity (day)</b>	20
<b>Light craft mass</b>	48,000 kg (105,821lbs)	<b>Passenger capacity (night)</b>	8+2
<b>Clearance</b>	7.75 m (25.4')	<b>Designer</b>	Marcio Schaefer
<b>Deadrise angle</b>	14°		











**SCHAEFER**

YACHTS

---

A U S T R A L I A